

**Megapress with SC-Contur**

Piping technology  
steel

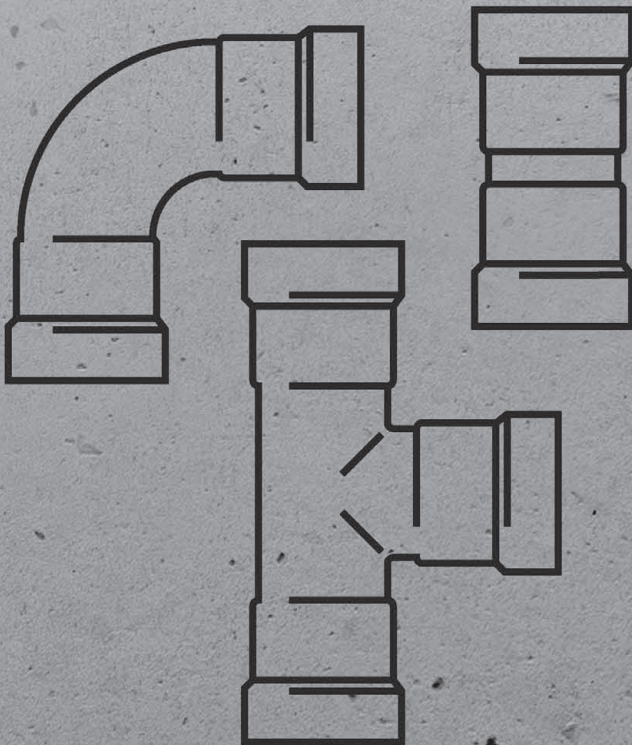

**Press connector system with press connectors made of non-alloy steel 1.0308 for black, galvanised, industrially painted and powder-coated steel pipes in acc. with DIN EN 10255 and in acc. with DIN EN 10220 / DIN EN 10216-1 as well as DIN EN 10220 / DIN EN 10217-1.**

**Press connectors**

Megapress press connectors are made of steel 1.0308 with an external galvanic zinc-nickel coating.  
 All sizes with SC-Contur – connections, which remain unpressed become visible when the system is filled. The SC-Contur fulfils the requirements of DVGW worksheet W 534, point 12.14, connectors with forced leakage.  
 During leakage tests with water, Viega guarantees the identification of unpressed connections in the pressure range 0.1 MPa–0.65 MPa, in the case of a dry leakage test with compressed air or noble gases from 22 hPa–0.3 MPa.

**Marking**

Black dot, black rectangle with symbol »Not for drinking water installations«



**Sealing elements**

EPDM, black (ethylene-propylene-dien-monomer rubber); not resistant against hydrocarbon solvent, chlorinated hydrocarbon solvents, turpentine, petrol

**Dimensions**

D $\frac{3}{8}$  (DN10); D $\frac{1}{2}$  (DN15); D $\frac{3}{4}$  (DN20); D1 (DN25); D1 $\frac{1}{4}$  (DN32); D1 $\frac{1}{2}$  (DN40); D2 (DN50); external-Ø 44,5 (DN32); external-Ø 57,0 (DN50)  
 D=Pipe diameter in acc. with DIN EN 10255

**Areas of application**

- Closed heating systems
- Closed cooling and heating circuits
- Compressed air system
- Industrial and plant engineering
- Fire extinguisher and sprinkler units
- Systems for technical gases (request required)

Use of the system for application areas and media other than those described here must be agreed with Viega Service Center.

**Operating conditions**

- Operating temperature max. 110 °C (EPDM)
- Operating pressure max. 1.6 MPa (PN 16)

**Note**

Megapress is suitable for

- Fire extinguisher and sprinkler units (required minimum wall thickness and maximum wall thickness need to be considered)
- For pipes in acc. with DIN EN 10220 / DIN EN 10216-1 / DIN EN 10217-1:

raw line 1: D $\frac{3}{8}$ –D2  
 raw line 2: external-Ø 57,0  
 raw line 3: external-Ø44,5

The Megapress system is not suitable for

- combustible gases in acc. with DVGW worksheet G 260
- Drinking water installations and other open systems

Megapress components may only be used with components that belong to the system!

**Protection against external corrosion**

Thanks to a high-quality zinc-nickel coating the press connectors are optimally protected against corrosion - e.g.

when condensation water forms in cooling systems.

The pipe being use should be protected with suitable corrosion prevention measures - observe manufacturer's information. Pipes and connectors should be insulated in the same way in acc. with the general rules of engineering.

**Use of press tools**

The functional safety of the Viega press connector systems is primarily dependent on the perfect condition of the press tools and press machines used. For this reason, for the production of press connections, we recommend the use of Viega press tools and their regular inspection by authorised service points.

**Technical data**

Press connectors and components are constantly being optimised. If required, the current Z and installation dimensions can be obtained from the download area of the Viega homepage: viega.com

**INDEX**

Elbows	4
T-pieces	5
Adapter pieces/adapter elbows	6
Press-in connections	7
Couplings	8
Reductions	8
Screw fittings	9
Caps	9
Flanges	10



**GTIN-Code (Global Trade Item Number, previously EAN-Code)**

The GTIN-Code composed out of the constant manufacturer number 4015211 and a six-digit article code - in this example 305 611. The exchange of the last six digits against the article code shows the GTIN-Code.

**ELBOWS**

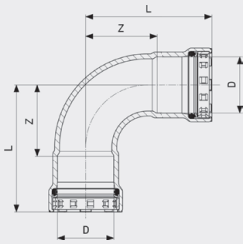

**Megapress Elbow 90°**  
- non-alloyed steel, zinc-nickel coating  
**Model 4216**

article	VdS	DN	D	Z	L
739 362		10	3/8	25	49
694 517		15	1/2	30	57
694 524	✓	20	3/4	35	64
694 531	✓	25	1	44	78
694 548	✓	32	1 1/4	51	97
694 555	✓	40	1 1/2	58	105
694 562	✓	50	2	71	121

VdS = VdS certification

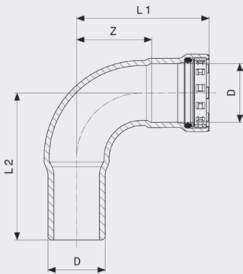

**Megapress Elbow 90°**  
- non-alloyed steel, zinc-nickel coating  
**Model 4216.1**

article	VdS	DN	D	Z	L1	L2
739 386		10	3/8	25	49	56
694 630		15	1/2	30	57	65
694 647	✓	20	3/4	35	64	71
694 654	✓	25	1	44	78	86
694 661	✓	32	1 1/4	51	97	102
694 678	✓	40	1 1/2	58	105	107
694 685	✓	50	2	71	121	129

VdS = VdS certification

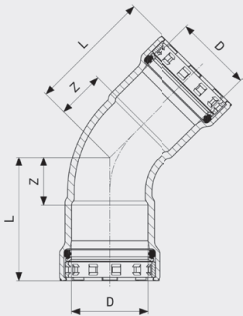

**Megapress Elbow 45°**  
- non-alloyed steel, zinc-nickel coating  
**Model 4226**

article	VdS	DN	D	Z	L
739 379		10	3/8	13	37
694 579		15	1/2	15	42
694 586	✓	20	3/4	18	48
694 593	✓	25	1	22	56
694 609	✓	32	1 1/4	25	71
694 616	✓	40	1 1/2	28	76
694 623	✓	50	2	34	84

VdS = VdS certification

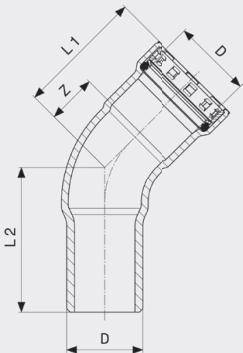

**Megapress Elbow 45°**  
- non-alloyed steel, zinc-nickel coating  
**Model 4226.1**

article	VdS	DN	D	Z	L1	L2
739 393		10	3/8	13	37	43
694 692		15	1/2	15	42	50
694 708	✓	20	3/4	18	48	54
694 715	✓	25	1	22	56	64
694 722	✓	32	1 1/4	25	71	76
694 739	✓	40	1 1/2	28	76	78
694 746	✓	50	2	34	84	91

VdS = VdS certification

T-PIECES

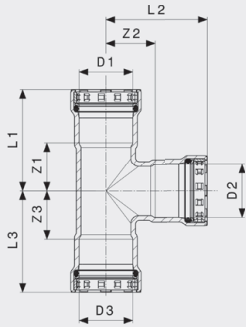

**Megapress T-piece**  
 - non-alloyed steel, zinc-nickel coating  
**Model 4218**

article	VdS	DN	D1	D2	D3	Z1	Z2	Z3	L1	L2	L3
739 423		10	3/8	3/8	3/8	22	21	22	46	45	46
694 968		15	1/2	1/2	1/2	25	24	25	52	51	52
695 026		20	3/4	1/2	3/4	28	27	28	58	54	58
694 975	✓	20	3/4	3/4	3/4	28	28	28	58	57	58
695 033		25	1	1/2	1	31	31	31	65	58	65
695 040	✓	25	1	3/4	1	31	32	31	65	61	65
699 024	✓	25	1	1	1	31	32	31	65	66	65
747 794		32	1 1/4	1/2	1 1/4	36	34	36	82	61	82
695 057	✓	32	1 1/4	3/4	1 1/4	36	35	36	82	65	82
695 095	✓	32	1 1/4	1	1 1/4	36	35	36	82	69	82
694 999	✓	32	1 1/4	1 1/4	1 1/4	36	35	36	82	81	82
695 064		40	1 1/2	1/2	1 1/2	40	37	40	87	64	87
695 071	✓	40	1 1/2	3/4	1 1/2	40	38	40	87	67	87
695 101	✓	40	1 1/2	1	1 1/2	40	38	40	87	72	87
695 088	✓	40	1 1/2	1 1/4	1 1/2	40	38	40	87	84	87
695 002	✓	40	1 1/2	1 1/2	1 1/2	40	39	40	87	87	87
695 118		50	2	1/2	2	46	44	46	96	71	96
695 125	✓	50	2	3/4	2	46	46	46	96	75	96
695 132	✓	50	2	1	2	46	44	46	96	79	96
695 149	✓	50	2	1 1/4	2	46	45	46	96	92	96
695 156	✓	50	2	1 1/2	2	45	47	45	95	94	95
695 019	✓	50	2	2	2	45	46	45	95	96	95

VdS = VdS certification

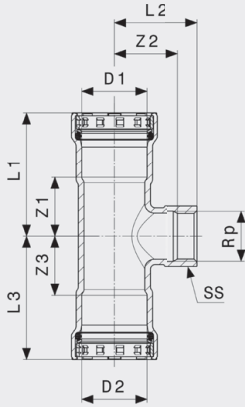

**Megapress T-piece**  
- non-alloyed steel, zinc-nickel coating  
**Model 4217.2**

article	VdS	DN	D1	Rp	D2	Z1	Z2	Z3	L1	L2	L3	SS
695 163		15	1/2	1/2	1/2	25	26	25	52	36	52	27
695 170	✓	20	3/4	1/2	3/4	28	29	28	58	39	58	27
695 187	✓	25	1	1/2	1	31	33	31	65	43	65	27
695 194	✓	25	1	3/4	1	31	34	31	65	44	65	32
695 200	✓	32	1 1/4	1/2	1 1/4	36	36	36	82	46	82	27
755 843	✓	32	1 1/4	3/4	1 1/4	36	30	36	82	46	82	32
755 959	✓	32	1 1/4	1	1 1/4	36	32	36	82	52	82	41
695 217	✓	40	1 1/2	1/2	1 1/2	40	39	40	87	49	87	27
695 224	✓	40	1 1/2	3/4	1 1/2	40	40	40	87	50	87	32
695 231	✓	40	1 1/2	1	1 1/2	40	43	40	87	54	87	41
695 248	✓	50	2	1/2	2	46	47	46	96	57	96	27
695 255	✓	50	2	3/4	2	46	48	46	96	58	96	32
695 262	✓	50	2	1	2	46	51	46	96	63	96	41

VdS = VdS certification  
SS = wrench size

**ADAPTER PIECES/ADAPTER ELBOWS**

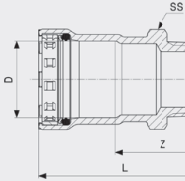

**Megapress Adapter**  
- non-alloyed steel, zinc-nickel coating  
**Model 4211**

article	VdS	DN	D	R	Z	L	SS
740 177		10	3/8	3/8	33	57	24
740 160		10	3/8	1/2	37	61	24
695 279		15	1/2	1/2	37	64	27
695 286	✓	20	3/4	3/4	40	70	32
695 293	✓	25	1	1	43	78	41
695 309	✓	32	1 1/4	1 1/4	48	94	46
695 316	✓	40	1 1/2	1 1/2	49	97	55
695 323	✓	50	2	2	54	104	70

VdS = VdS certification  
SS = wrench size

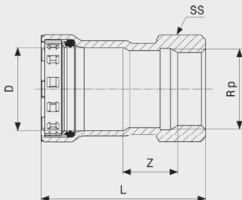

**Megapress Adapter**  
- non-alloyed steel, zinc-nickel coating  
**Model 4212**

article	VdS	DN	D	Rp	Z	L	SS
740 184		10	3/8	3/8	17	52	24
740 191		10	3/8	1/2	17	56	27
695 330		15	1/2	1/2	21	58	27
695 347	✓	20	3/4	3/4	23	62	32
695 354	✓	25	1	1	23	69	41
695 361	✓	32	1 1/4	1 1/4	24	85	46
695 378	✓	40	1 1/2	1 1/2	25	86	55
695 385	✓	50	2	2	25	92	70

VdS = VdS certification  
SS = wrench size

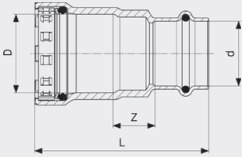

**Megapress Adapter**  
- non-alloyed steel, zinc-nickel coating  
**Model 4213**

article	VdS	DN	D	d	Z	L
740 207		10	3/8	15	18	64
718 787		15	1/2	15	19	68
734 121		20	3/4	15	22	73
718 794	✓	20	3/4	22	19	71
734 138		25	1	15	23	79
718 800	✓	25	1	28	19	77
718 817	✓	32	1 1/4	35	19	91
718 824	✓	40	1 1/2	42	19	102
718 831	✓	50	2	54	20	110

VdS = VdS certification

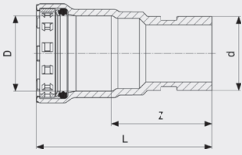

**Megapress Adapter**  
- non-alloyed steel, zinc-nickel coating  
**Model 4213.1**

article	VdS	DN	D	d	Z	L
718 343	✓	25	1	33.7	46	81
718 756	✓	32	1 1/4	42.4	46	92
718 763	✓	40	1 1/2	48.3	47	95
718 770	✓	50	2	60.3	47	97

VdS = VdS certification

**PRESS-IN CONNECTIONS**

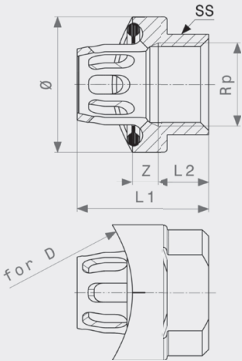

**Megapress Press-in branch connector**  
- non-alloyed steel, zinc-nickel coating  
**Model 4212.2**

article	for D	Rp	Z	L1	L2	Ø	SS
731 168	1 1/2	3/4	7	42	16	43	32
731 175	2	3/4	8	42	16	43	32
731 182	2 1/2	3/4	8	42	16	43	32
731 199	3	3/4	8	42	16	43	32
731 205	4	3/4	8	42	16	43	32
731 212	5	3/4	8	42	16	43	32
731 229	6	3/4	8	42	16	43	32

Ø = diameter  
SS = wrench size

**NEW**

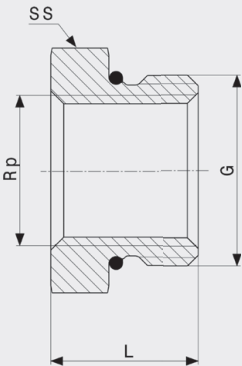

**Reducer**  
- gunmetal  
**Model 3241.1**

article	G	Rp	L	SS
731 236	3/4	1/2	20	32

SS = wrench size

**NEW**

**COUPLINGS**

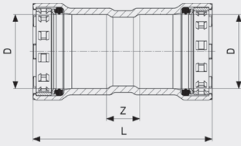

**Megapress Coupling**  
- non-alloyed steel, zinc-nickel coating  
**Model 4215**

article	VdS	DN	D	Z	L
739 409		10	3/8	12	60
694 753		15	1/2	15	68
694 760	✓	20	3/4	16	75
694 777	✓	25	1	16	84
694 784	✓	32	1 1/4	18	110
694 791	✓	40	1 1/2	23	118
694 807	✓	50	2	20	120

VdS = VdS certification

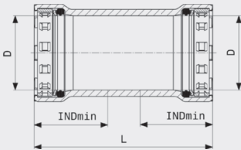

**Megapress Sliding coupling**  
- non-alloyed steel, zinc-nickel coating  
**Model 4215.5**

article	VdS	DN	D	INDmin	L
739 416		10	3/8	24	60
694 814		15	1/2	27	68
694 821	✓	20	3/4	29	75
694 838	✓	25	1	34	84
694 845	✓	32	1 1/4	46	110
694 852	✓	40	1 1/2	48	118
694 869	✓	50	2	50	120

VdS = VdS certification

INDmin = insertion depth minimum

**REDUCTIONS**

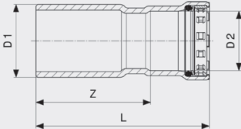

**Megapress Reducer**  
- non-alloyed steel, zinc-nickel coating  
**Model 4215.1**

article	VdS	DN1	D1	DN2	D2	Z	L
739 430		15	1/2	10	3/8	46	70
739 447		20	3/4	10	3/8	51	75
695 392		20	3/4	15	1/2	45	72
695 408		25	1	15	1/2	54	82
695 415	✓	25	1	20	3/4	53	82
695 422		32	1 1/4	15	1/2	73	100
695 439	✓	32	1 1/4	20	3/4	72	101
695 446	✓	32	1 1/4	25	1	67	101
695 453		40	1 1/2	15	1/2	78	105
695 460	✓	40	1 1/2	20	3/4	76	105
695 477	✓	40	1 1/2	25	1	71	106
695 484	✓	40	1 1/2	32	1 1/4	69	115
695 491		50	2	15	1/2	87	114
695 507	✓	50	2	20	3/4	85	114
695 514	✓	50	2	25	1	80	114
695 521	✓	50	2	32	1 1/4	77	123
695 538	✓	50	2	40	1 1/2	75	123

VdS = VdS certification

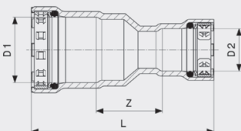

**Megapress Reducing coupling**  
- non-alloyed steel, zinc-nickel coating  
**Model 4215.2**

article	DN1	D1	DN2	D2	Z	L
734 145	20	3/4	15	1/2	30	87
734 152	25	1	15	1/2	35	96

**NEW**



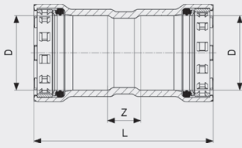

**NEW**

**Megapress Reducing coupling**  
- non-alloyed steel, zinc-nickel coating  
**Model 4215.7**

article	DN1	D	DN2	external-Ø	Z	L
754 853 <sup>1</sup>	40	1½	32	44.5	19	114
754 648 <sup>2</sup>	50	2	50	57	21	120

<sup>1</sup>) for steel pipes in smoke tube quality pipe range 3  
<sup>2</sup>) for steel pipes in smoke tube quality pipe range 2

**SCREW FITTINGS**

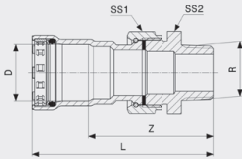

**Megapress Adapter union**  
- non-alloyed steel, zinc-nickel coating  
**Model 4265**

article	VdS	DN	D	R	Z	L	SS1	SS2
718 923		15	½	½	66	93	30	27
718 909	✓	20	¾	¾	71	100	37	34
718 893	✓	25	1	1	77	111	46	46
718 916	✓	32	1¼	1¼	82	128	53	50
747 800	✓	40	1½	1½	84	132	60	55
747 817	✓	50	2	2	94	144	78	72

VdS = VdS certification  
SS = Spanner size  
SS = spanner size

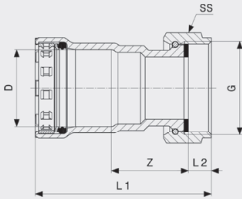

**Megapress Connection screw fitting**  
- non-alloyed steel, zinc-nickel coating  
**Model 4263**

article	VdS	DN	D	G	Z	L1	L2	SS
718 886		15	½	¾	33	69	8	30
718 855	✓	20	¾	1	33	70	8	37
718 848	✓	25	1	1¼	35	79	10	46
718 879	✓	25	1	1½	26	70	10	53
718 862	✓	32	1¼	1½	37	93	10	53
725 860	✓	32	1¼	2	28	88	14	66
747 824	✓	40	1½	1½	41	98	10	53
747 831	✓	50	2	2	45	109	14	66

VdS = VdS certification  
SS = wrench size

**CAPS**

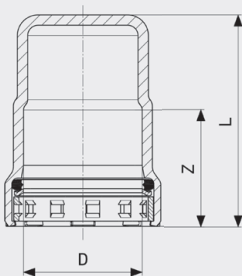

**Megapress Cap**  
- non-alloyed steel, zinc-nickel coating  
**Model 4256**

article	VdS	DN	D	Z	L
740 153		10	⅝	24	51
694 906		15	½	27	54
694 913	✓	20	¾	29	57
694 920	✓	25	1	34	62
694 937	✓	32	1¼	46	74
694 944	✓	40	1½	48	77
694 951	✓	50	2	50	78

VdS = VdS certification

**FLANGES**

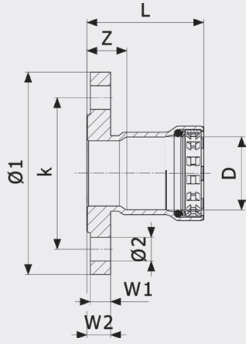

**Megapress Flange adapter**  
- non-alloyed steel, zinc-nickel coating  
**Model 4259.1**

article	DN	D	Z	L	W1	W2	Ø1	k	Ø2	n
721 978	32	1¼	24	70	12	14	120	90	14	4
721 985	40	1½	24	72	12	14	130	100	14	4
721 992	50	2	24	74	12	14	140	110	14	4

Ø = diameter  
k = bolt circle diameter  
Ø = diameter  
n = number of holes

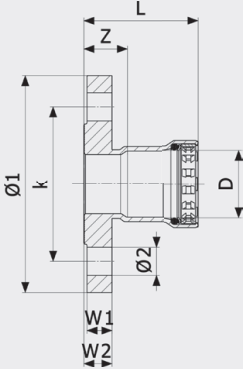

**Megapress Flange adapter**  
- non-alloyed steel, zinc-nickel coating  
**Model 4259**

article	VdS	DN	D	Z	L	W1	W2	Ø1	k	Ø2	n
694 876	✓	32	1¼	28	74	16	18	140	100	18	4
694 883	✓	40	1½	28	76	16	18	150	110	18	4
694 890	✓	50	2	27	77	16	18	165	125	18	4

VdS = VdS certification  
Ø = diameter  
k = bolt circle diameter  
Ø = diameter  
n = number of holes

order code	page	order code	page	order code	page	order code	page	order code	page
694 517	4	695 262	6	740 160	6				
694 524	4	695 279	6	740 177	6				
694 531	4	695 286	6	740 184	6				
694 548	4	695 293	6	740 191	6				
694 555	4	695 309	6	740 207	7				
694 562	4	695 316	6	747 794	5				
694 579	4	695 323	6	747 800	9				
694 586	4	695 330	6	747 817	9				
694 593	4	695 347	6	747 824	9				
694 609	4	695 354	6	747 831	9				
694 616	4	695 361	6	754 648	9				
694 623	4	695 378	6	754 853	9				
694 630	4	695 385	6	755 843	6				
694 647	4	695 392	8	755 959	6				
694 654	4	695 408	8						
694 661	4	695 415	8						
694 678	4	695 422	8						
694 685	4	695 439	8						
694 692	4	695 446	8						
694 708	4	695 453	8						
694 715	4	695 460	8						
694 722	4	695 477	8						
694 739	4	695 484	8						
694 746	4	695 491	8						
694 753	8	695 507	8						
694 760	8	695 514	8						
694 777	8	695 521	8						
694 784	8	695 538	8						
694 791	8	699 024	5						
694 807	8	718 343	7						
694 814	8	718 756	7						
694 821	8	718 763	7						
694 838	8	718 770	7						
694 845	8	718 787	7						
694 852	8	718 794	7						
694 869	8	718 800	7						
694 876	10	718 817	7						
694 883	10	718 824	7						
694 890	10	718 831	7						
694 906	9	718 848	9						
694 913	9	718 855	9						
694 920	9	718 862	9						
694 937	9	718 879	9						
694 944	9	718 886	9						
694 951	9	718 893	9						
694 968	5	718 909	9						
694 975	5	718 916	9						
694 999	5	718 923	9						
695 002	5	721 978	10						
695 019	5	721 985	10						
695 026	5	721 992	10						
695 033	5	725 860	9						
695 040	5	731 168	7						
695 057	5	731 175	7						
695 064	5	731 182	7						
695 071	5	731 199	7						
695 088	5	731 205	7						
695 095	5	731 212	7						
695 101	5	731 229	7						
695 118	5	731 236	7						
695 125	5	734 121	7						
695 132	5	734 138	7						
695 149	5	734 145	8						
695 156	5	734 152	8						
695 163	6	739 362	4						
695 170	6	739 379	4						
695 187	6	739 386	4						
695 194	6	739 393	4						
695 200	6	739 409	8						
695 217	6	739 416	8						
695 224	6	739 423	5						
695 231	6	739 430	8						
695 248	6	739 447	8						
695 255	6	740 153	9						

model no.	page	model no.	page	model no.	page	model no.	page	model no.	page
3241.1	7								
4211	6								
4212	6								
4212.2	7								
4213	7								
4213.1	7								
4215	8								
4215.1	8								
4215.2	8								
4215.5	8								
4215.7	9								
4216	4								
4216.1	4								
4217.2	6								
4218	5								
4226	4								
4226.1	4								
4256	9								
4259	10								
4259.1	10								
4263	9								
4265	9								